

# Historic Courthouse Ground Improvements

## Base Scope of Work

Item	Description	Estimated Cost	
Sidewalk Demolition	Remove all existing sidewalks. Approx. 10,915sf	\$	18,500.00
Sidewalk Installation	Pour new sidewalks w/ #3 rebar	\$	87,500.00
	Subtotal for Sidewalk	\$	106,000.00
Irrigation System	Install new irrigation system	\$	28,850.00
Wall Detail #3	30" avg ht, poured in place, natural color @ \$82.14 per LF	\$	32,856.00
Sod	Sod 10ft either side of sidewalks	\$	11,250.00
Miscellaneous	Dirt for backfilling and grading	\$	15,000.00
	<b>Estimated Cost</b>	\$	<b>193,956.00</b>
<b>Option for Retaining Wall in Base Scope of Work</b>		<b>Per LF Cost</b>	<b>400 LF</b>
Wall Detail 2	30" avg ht, brick cap	\$ 132.00	\$ 52,800.00
Wall Detail 2	30" avg ht, cast stone cap	\$ 157.00	\$ 62,800.00
<b>Add Alternate</b>	<b>Complete wall around perimeter</b>		
Wall Detail 1	24" ht. or less, brick cap	\$ 67.71	\$ 74,481.00
Wall Detail 1	24" ht. or less, cast stone cap	\$ 82.80	\$ 91,080.00
Concrete Wall	Poured in place wall	\$ 82.14	\$ 90,354.00
Miscellaneous	Dirt for backfilling and grading		\$ 20,000.00
Sod	Remainder of property		\$ 55,200.00



SCALE: 1"=20'

BASE INFORMATION IS PER ELECTRONIC SURVEY PREPARED BY RICHARD TOLBERT, UTILITY LOCATIONS PER SURVEY AND B1 MARKINGS.

D R A F T

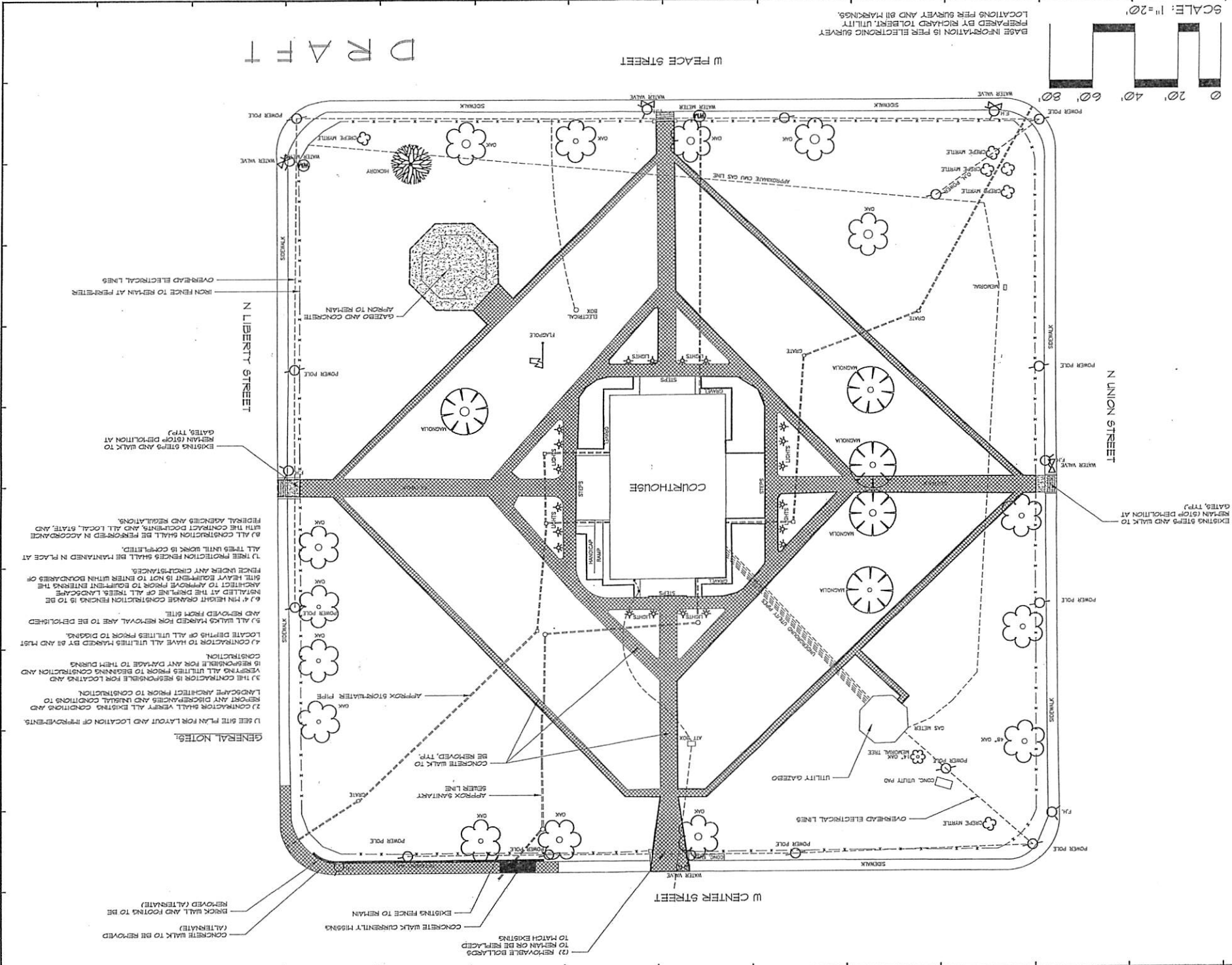

- GENERAL NOTES:**
- 1) SEE SITE PLAN FOR LAYOUT AND LOCATION OF IMPROVEMENTS.
  - 2) CONTRACTOR SHALL VERIFY ALL EXISTING CONDITIONS AND REPORT ANY DISCREPANCIES AND UNUSUAL CONDITIONS TO LANDSCAPE ARCHITECT PRIOR TO CONSTRUCTION.
  - 3) THE CONTRACTOR IS RESPONSIBLE FOR LOCATING AND VERIFYING ALL UTILITIES PRIOR TO BEGINNING CONSTRUCTION AND IS RESPONSIBLE FOR ANY DAMAGE TO THEM DURING CONSTRUCTION.
  - 4) CONTRACTOR TO HAVE ALL UTILITIES MARKED BY 88 AND MUST LOCATE DEPTHS OF ALL UTILITIES PRIOR TO DIGGING.
  - 5) ALL WALKS MARKED FOR REMOVAL ARE TO BE DEMOLISHED AND REMOVED FROM SITE.
  - 6) ALL EXISTING CONSTRUCTION FENCING IS TO BE REINSTALLED AT THE DRIVING LINE OF ALL TREES. LANDSCAPE ARCHITECT TO APPROVE PRIOR TO EQUIPMENT ENTERING THE SITE. HEAVY EQUIPMENT IS NOT TO ENTER WITHIN BOUNDARIES OF FENCE UNDER ANY CIRCUMSTANCES.
  - 7) TREE PROTECTION FENCES SHALL BE MAINTAINED IN PLACE AT ALL TIMES UNTIL WORK IS COMPLETED.
  - 8) ALL CONSTRUCTION SHALL BE PERFORMED IN ACCORDANCE WITH THE CONTRACT AND ALL LOCAL, STATE, AND FEDERAL AGENCIES AND REGULATIONS.

LANDSCAPE DEVELOPMENT PLANS  
**MADISON COUNTY COURTHOUSE**  
 CANTON, MS 39046  
 PREPARED FOR:  
 MADISON COUNTY BOARD OF SUPERVISORS

**HAYGOOD**  
 C . R . O . U . P  
 Landscape Architect/Land Planners



571 Highway 71, Sibley C-Ridge/Land, MS 39157  
 601.966.3581 • www.haygoodgroup.com

SHEET TITLE: DEMOLITION PLAN  
 PROJECT NO.:  
 CHECKED BY:  
 DATE DRAWN: 3/17/19  
 REVISIONS:

DATE	REVISIONS

This drawing is an instrument of service and shall not be copied or reproduced in any manner without written permission.  
 SHEET NUMBER: 1 OF 5



**HAYGOOD**  
C.R.O.U.P.  
Landscape Architects/Land Planners

571 Highway 51, Suite C • Ridgeland, MS 39157  
601.366.3581 • www.GaryHaygoodDesign

LANDSCAPE DEVELOPMENT PLANS  
**MADISON COUNTY, MS  
COURTHOUSE**  
Canton, MS

PREPARED FOR:  
Madison County Board of Supervisors

SHEET TITLE:  
SITE PLAN

PROJECT NO:  
DATE DRAWN: 3/21/13  
DRAWN BY:  
CHECKED BY:  
REVISED:  
DATE | REVISIONS

This drawing is an instrument of service and remains the property of The Haygood Group. It may not be copied or reproduced in any manner without written permission.

SHEET NUMBER:  
**2**  
OF 5

- GENERAL NOTES:**
- SEE DEMOLITION PLAN FOR APPROXIMATE EXISTING UTILITY LOCATIONS.
  - PROVIDE EXPANSION JOINTS PER WALK DETAIL WHERE WALKS MEET CURBS, STEPS, WALLS, OR FIXED SLABS.
  - CAD FILE WILL BE PROVIDED TO CONTRACTOR FOR STAKING OF WALKS AND OTHER LANDSCAPE ELEMENTS.
  - THE CONTRACTOR SHALL MAINTAIN ALL GRABBED AREAS TO THE GREATEST EXTENT POSSIBLE.
  - ALL AREAS THAT ARE DISTURBED BY CONSTRUCTION INSIDE OR OUTSIDE THE LIMIT OF WORK SHALL BE REPAIRED, GRADED AND GRASSED AT THE CONTRACTOR'S EXPENSE.
  - 6'-4" MIN HEIGHT ORANGE CONSTRUCTION FENCING IS TO BE INSTALLED AT THE DRIPLINE OF ALL TREES. LANDSCAPE ARCHITECT TO APPROVE PRIOR TO EQUIPMENT ENTERING THE SITE. HEAVY EQUIPMENT IS NOT TO ENTER WITHIN BOUNDARIES OF FENCE UNDER ANY CIRCUMSTANCES.
  - TREE PROTECTION FENCES SHALL BE MAINTAINED IN PLACE AT ALL TIMES UNTIL WORK IS COMPLETED.
  - ALL CONSTRUCTION SHALL BE PERFORMED IN ACCORDANCE WITH THE CONTRACT DOCUMENTS, AND ALL LOCAL, STATE, AND FEDERAL AGENCIES AND REGULATIONS.
  - CONTRACTOR SHALL STAKE ALL WORK TO BE COMPLETED AND OBTAIN APPROVAL FROM LANDSCAPE ARCHITECT PRIOR TO CONSTRUCTION. ANY DISCREPANCIES SHALL BE RESOLVED PRIOR TO CONSTRUCTION.
  - ALL EXISTING TREES AND PLANTINGS ARE TO REMAIN. THERE IS TO BE NO MECHANICAL DIGGING OR TILLING WITHIN DRIPLINE OF TREES, ONLY HAND TOOLS. SEE ADDITIONAL NOTES ON IRRIGATION PLAN.

NOTE: PROVIDE EXPANSION JOINTS • ALL EXISTING VERTICAL SURFACES AND AS SHOWN ON SITE PLAN USING STEELREINFORCED CONCRETE. FRONTIER POLY-VINYL "ZIP STRIP" MATERIAL (1/2" x 3"). CALLIC, BASE ANODIZED ALUMINUM.

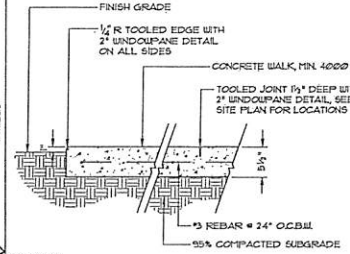

CONCRETE WALK  
SCALE: 1"=1'-0"

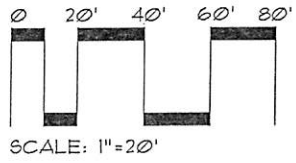
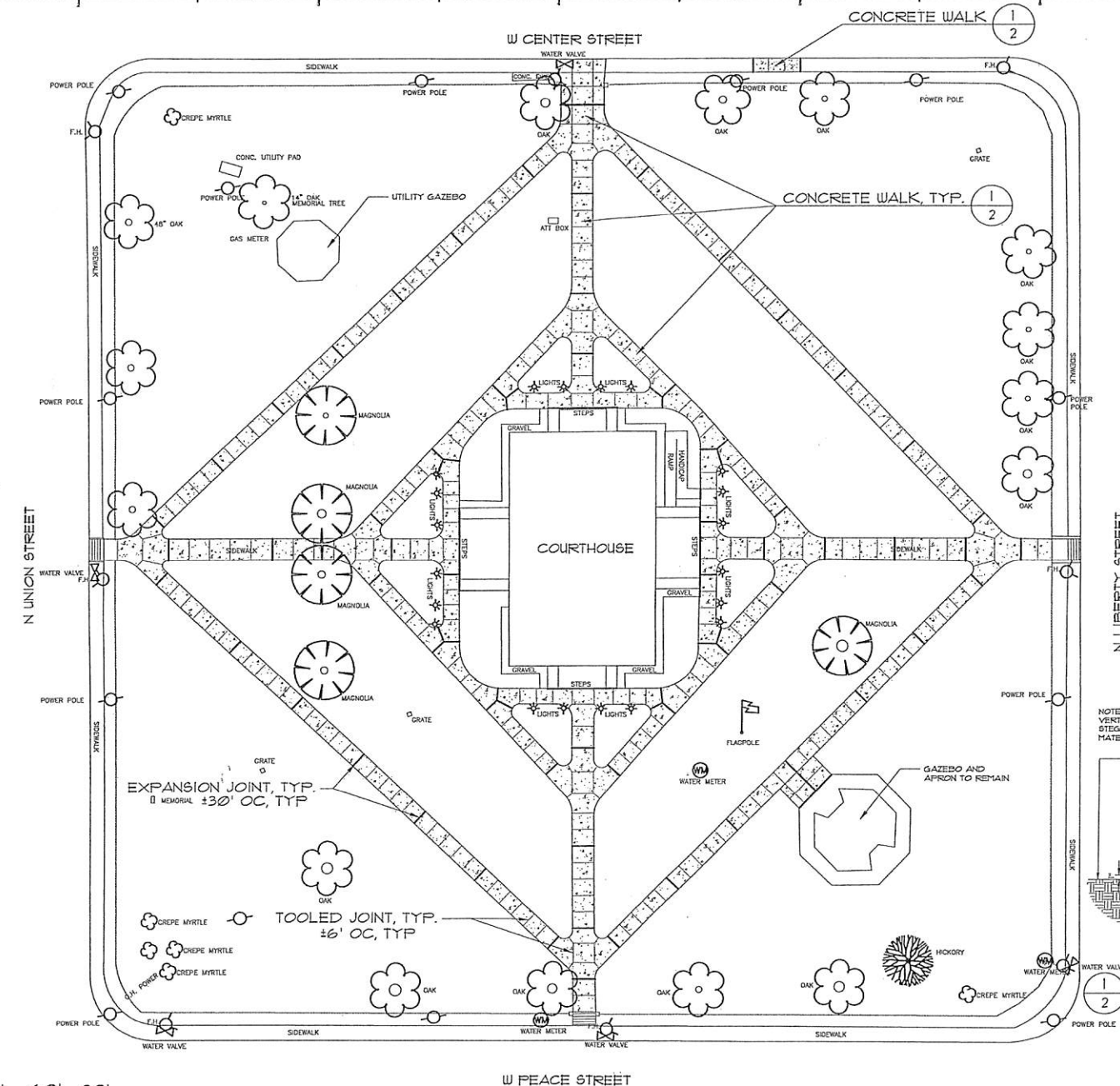

BASE INFORMATION IS PER ELECTRONIC SURVEY PREPARED BY RICHARD TOLBERT. UTILITY LOCATIONS PER SURVEY AND APPROXIMATE 811 MARKINGS.

DRAFT



**HAYGOOD**  
G.R.O.U.P.  
Landscape Architects/Land Planners

571 Highway 51, Suite C, Ridgeland, MS 39157  
601.966.3581 • www.GaryHaygood.Design

LANDSCAPE DEVELOPMENT PLANS  
**MADISON COUNTY, MS**  
**COURTHOUSE**  
Canton, MS

PREPARED FOR:  
Madison County Board of Supervisors

SHEET TITLE:  
PERIMETER  
TREATMENT PLAN

PROJECT NO:  
DATE DRAWN: 3/27/13  
DRAWN BY:  
CHECKED BY:  
REVISIONS:

DATE	REVISIONS

This drawing is an instrument of service and remains the property of The Haygood Group. It may not be copied or reproduced in any manner without written permission.

SHEET NUMBER:

**3**  
OF 5

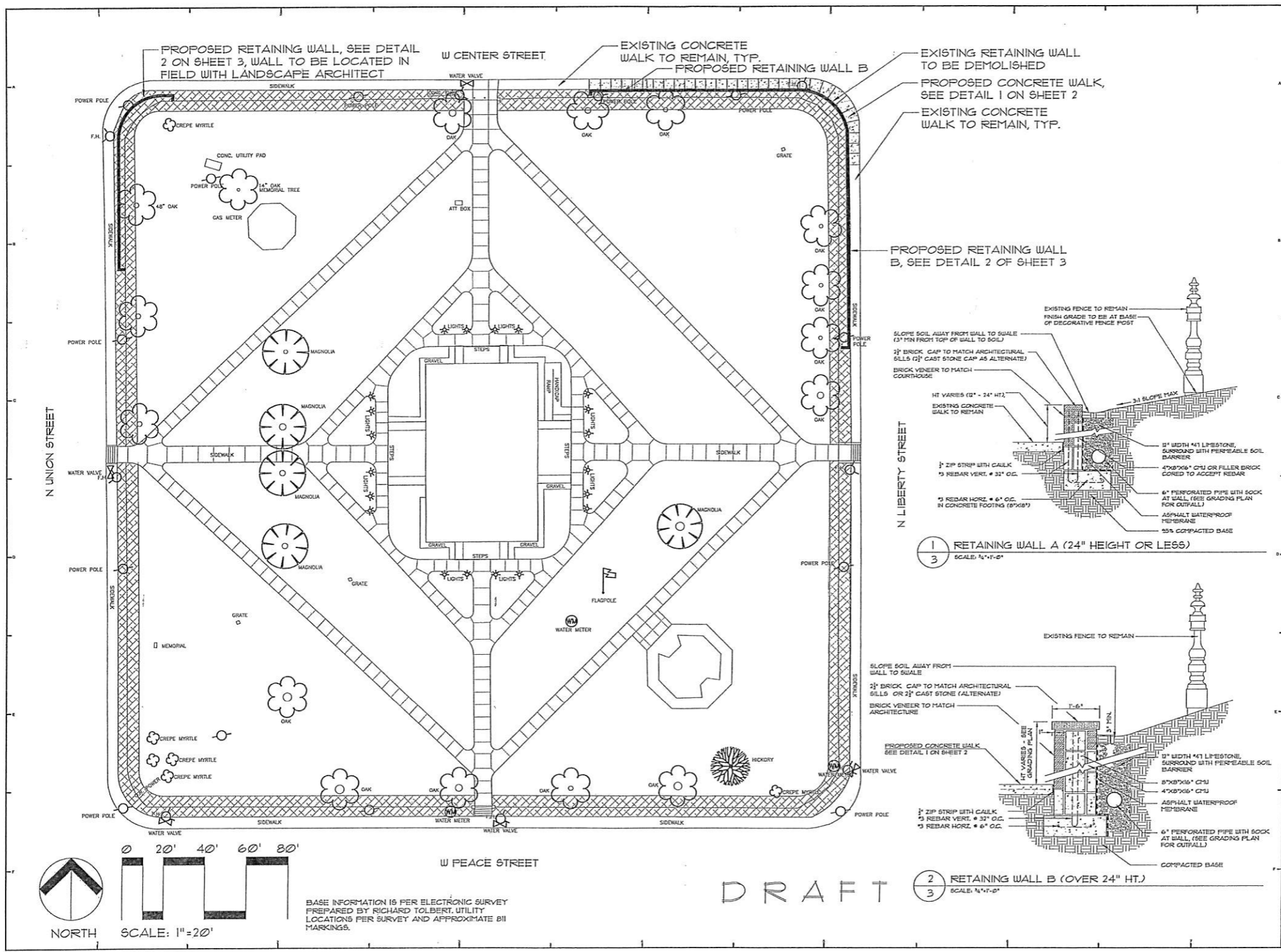

EXISTING RETAINING WALL TO BE DEMOLISHED  
PROPOSED CONCRETE WALK, SEE DETAIL 1 ON SHEET 2  
EXISTING CONCRETE WALK TO REMAIN, TYP.  
PROPOSED RETAINING WALL B, SEE DETAIL 2 OF SHEET 3

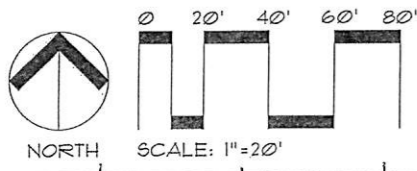
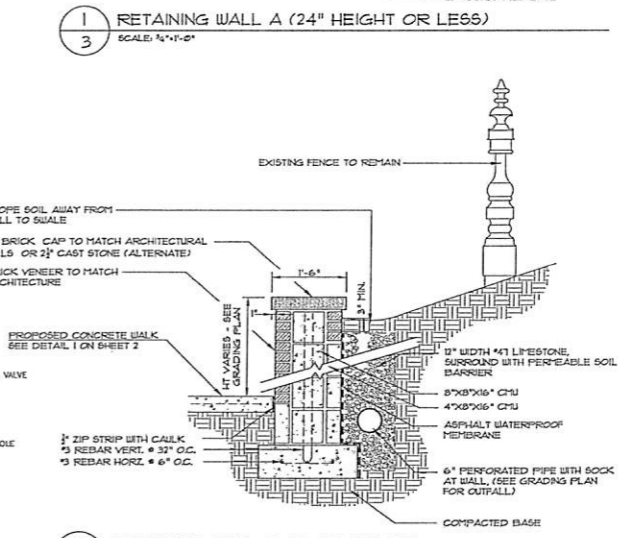
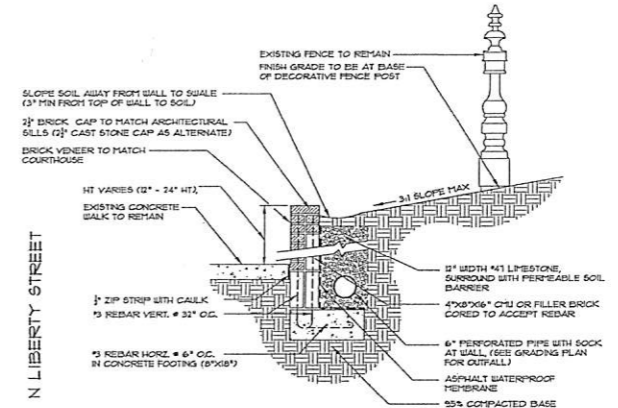

BASE INFORMATION IS PER ELECTRONIC SURVEY  
PREPARED BY RICHARD TOLBERT. UTILITY  
LOCATIONS PER SURVEY AND APPROXIMATE BIM  
MARKINGS.

DRAFT

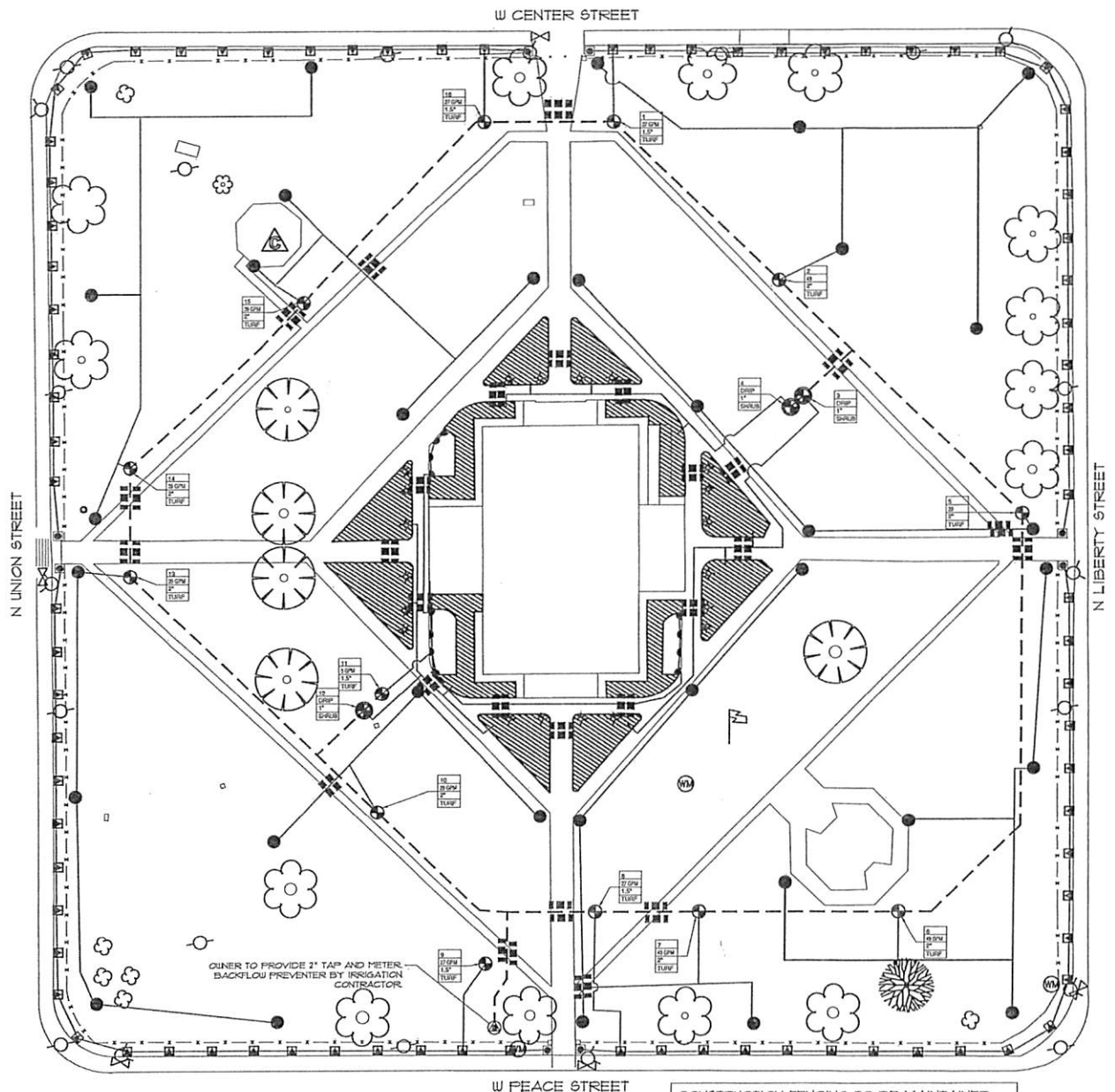

**PIPE SIZING CHART:**

SIZE	GALLONS
1/2"	0-5
3/4"	6.1-10
1"	10.1-17
1 1/4"	17.1-26
1 1/2"	26.1-36
2"	36.1-55



**Irrigation**

Symbol	Description	Part #	Pressure	Flow	Radius
▲	Rain Bird 6H	6H	30	0.52	5
▼	Rain Bird 6Q	6Q	30	0.26	5
■	Rain Bird 155ST	155ST	30	1.21	30
□	Rain Bird 155ET	155ET	30	4.2	30
●	Rain Bird Falcon 4504 (must have RainbirdTSL 100 wiring job)	#12 Nozzle	40	9.7	55
■	Rainbird XFD-01-16				
⊙	2" DCA				
⊙	Rain Bird FEB (200 for rotor zones, 150 for spray zones)				
⊙	KCZ-PRB-100-CGF 1" COMMERCIAL				
▲	ESP LXME				
⊙	2 inch meter				
---	Lateral Line - CL 200				
---	2.5" Mainline - CL 200				
■	(3) 4" PVC SLEEVES - BORE UNDER WALK AT EACH LOCATION				

- Irrigation Notes:**
- ALL MAINLINES AND LATERAL LINES TO BE 18" DEEP. SOIL SHALL BE COMPACTED USING A VIBRATORY PACKER OR HAND TAMP IN SIX INCH LIFTS WHERE TRENCHED.
  - ALL PIPE TO BE INSTALLED AS PER MANUFACTURERS' SPECIFICATIONS.
  - ALL THREADED JOINTS TO BE COATED WITH TEFLON TAPE OR LIQUID TEFLON.
  - SPRINKLER AND RELATED EQUIPMENT TO BE INSTALLED AS PER DETAILS.
  - ALL ELECTRICAL JOINTS TO BE MADE USING WATERPROOF CONNECTIONS AS SHOWN ON DETAILS.
  - NO ELECTRICAL CONNECTIONS SHALL BE MADE IN THE FIELD EXCEPT AT A VALVE CONTROL BOX OR ANOTHER VALVE BOX SPECIFICALLY FOR CONNECTIONS.
  - ALL 24 VOLT WIRE SHALL BE #12 UF/UL FOR COMMON WIRE, AND #14 UF/UL FOR CONTROL WIRES, DIRECT BURIAL, SOLID COPPER.
  - CONTRACTOR SHALL PROVIDE EXPANSION COILS AT EACH WIRE CONNECTION IN VALVE BOX (WRAP AROUND 3/4" PIPE 12 TIMES).
  - CONTRACTOR TO UTILIZE APPROPRIATE AUTOMATIC DRAIN DEVICE WHERE LOW HEAD DRAINAGE MAY OCCUR AND WHERE LINES ARE BROUGHT ABOVE GRADE AND RISK OF FREEZING IS PRESENT.
  - ALL SPRINKLERS TO BE MOUNTED ON 12" PLUMB PIPE OR SWAG JOINTS.
  - CONTRACTOR SHALL INSTALL A SEPARATE COMMON FOR EACH CONTROLLER.
  - 24 VOLT WIRE SHALL BE COLOR CODED; COMMON-WHITE, CONTROL-RED.
  - CONTRACTOR SHALL INSTALL MANUFACTURERS' RECOMMENDED GROUNDING EQUIPMENT FOR POWER SUPPLY AND VALVE OUTPUT WITH (2) 5/8" COPPER CLAD GROUND RODS.
  - CONTRACTOR SHALL INSTALL MANUFACTURERS' RECOMMENDATION ON FAULT GROUND AND LIGHTNING PROTECTION.
  - ADDITIONAL MATERIAL TO BE SUPPLIED BY CONTRACTOR TO OWNER:
    - TWO BRANCHES FOR DISASSEMBLING AND ADJUSTING EACH TYPE OF SPRINKLER HEADS AND VALVE SUPPLIED.
    - TWO KEYS FOR EACH OF THE AUTOMATIC CONTROLLERS.
  - ALL IRRIGATION EQUIPMENT TO BE INSTALLED ACCORDING TO SPECIFICATIONS AND DETAILS.
  - CONTRACTOR TO ADD EXTENSION RISER TO POP-UP HEADS WHEN NEEDED FOR PROPER COVERAGE.
  - CONTRACTOR SHALL INSTALL SPRINKLER EQUIPMENT 12" FROM FOUNDATIONS. ALSO INSTALL SPRINKLERS 4" FROM CURB OR WALKS.
  - ALL MAIN AND LATERAL LINE PIPING TO BE CLASS 200 PVC.
  - ADHERE TO LOCAL PLUMBING AND ELECTRICAL REQUIREMENTS.
  - SPRAY HEADS IN LAWN AREAS WILL BE 4" POP-UP HEIGHT.
  - SPRAY HEADS IN SHRUB AREAS WILL BE 12" POP-UP HEIGHT.
  - ALL SOIL SHALL BE ZONED SEPARATELY FROM SHRUB AND SEASONAL COLOR ZONES.
  - INSTALL ALL LINES UNDER ROADWAYS AND SIDEWALKS IN SCHEDULE 40 PVC SLEEVES, PER SLEEVING SCHEDULE.
  - SYSTEM DESIGN SHALL ALLOW ENTIRE PLANTED AREA TO BE IRRIGATED WITH 3/4" OF WATER ONCE EVERY FOUR DAYS.
  - CONTRACTOR TO PERFORM PRESSURE TEST PRIOR TO BEGINNING SYSTEM INSTALLATION TO VERIFY THAT A MINIMUM OF 70 PSI AND 50 GPM ARE AVAILABLE AT THE SOURCE AND SHALL SUBMIT FINDINGS TO ARCHITECT.
  - INSTALL CONCRETE DONUT, FLUSH MOUNTED WITH EXISTING GRADE FOR ALL TURF HEADS.

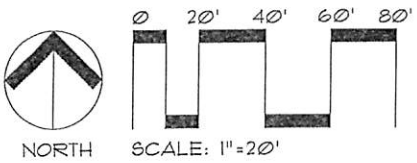

BASE INFORMATION IS PER ELECTRONIC SURVEY PREPARED BY RICHARD TOLBERT. UTILITY LOCATIONS PER SURVEY AND APPROXIMATE 811 MARKINGS.

CONSTRUCTION FENCING TO BE MAINTAINED AT THE DRIPLINES OF ALL TREES FOR THE ENTIRETY OF THE CONSTRUCTION PHASE. DO NOT MECHANICALLY TRENCH WITHIN THE DRIP AREA OF EXISTING TREES. HAND DIGGING MAY BE ALLOWED ONLY IF PROPOSED LINES CAN NOT BE RELOCATED OUT OF DRIPLINE. ANY DIGGING WITHIN DRIPLINES OF TREES IS TO BE APPROVED BY LANDSCAPE ARCHITECT PRIOR TO CONSTRUCTION.

LANDSCAPE DEVELOPMENT PLANS  
**MADISON COUNTY, MS**  
**COURTHOUSE**  
 Canton, MS  
 PREPARED FOR:  
 Madison County Board of Supervisors

SHEET TITLE:  
IRRIGATION PLAN

PROJECT NO.:  
DATE DRAWN: 3/27/15  
DRAWN BY:  
CHECKED BY:  
REVISIONS:

DATE	REVISIONS

This drawing is an instrument of service and remains the property of The Haygood Group. It may not be copied or reproduced in any manner without written permission.

SHEET NUMBER:  
**4**  
 OF 5

